

# K-PAD

## FLAT EDGE LED PANEL FOR UNDER CABINET LIGHTING

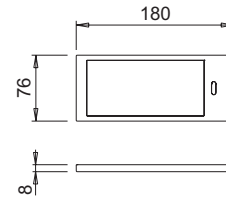

**K-PAD** is an LED panel of only 8mm thick designed for quick installation, thanks to the slide bracket supplied. The device integrates a special EDGE LED cluster which guarantees a wide projection beam and allows homogeneous illumination of the working plane. K-PAD is also configured with a dimming switch to regulate the intensity of light.

### FEATURES

**Material:** thermoplastic polymers

**Finish:** steel

**Light source:** SMD EDGE LED

**Connector:** Micro24

**Wiring:** 2000mm

**Application type:** under cabinet, under shelf

**Installation:** surface

### K-PAD slave without switch

UFORM CODE	WATT & VOLT	LIGHT COLOUR	FINISH	PER PACK
LG-KPADSLAVENW	5W @ 24Vdc	Natural white	Steel	1
LG-KPADSLAVEWW	5W @ 24Vdc	Warm white	Steel	1

**Led converter not included. To be ordered separately.**

### K-PAD SDM with master infrared dimmable switch

UFORM CODE	WATT & VOLT	LIGHT COLOUR	FINISH	PER PACK
LG-KPADSDMNW	5W @ 24Vdc	Natural white	Steel	Set of 3
LG-KPADSDMWW	5W @ 24Vdc	Warm white	Steel	Set of 3

**Led converter included.**

### SET K-PAD SDM 3X with master infrared dimmable switch

UFORM CODE	WATT & VOLT	LIGHT COLOUR	FINISH	PER PACK
LG-KPADSDMNWX3	3x5W @ 230Vac	Natural white	Steel	Set of 3
LG-KPADSDMWWX3	3x5W @ 230Vac	Warm white	Steel	Set of 3

**Led converter not included. To be ordered separately.**

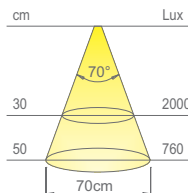
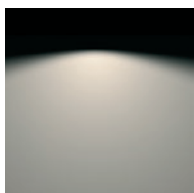

**Colour appearance** natural white

**Colour temperature** 4000 K

**Luminous flux** 275 lm

**Luminous efficiency** 55 lm/W

**CRI** Ra ≥ 80

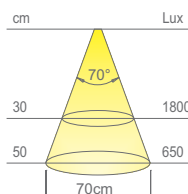
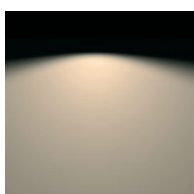

**Colour appearance** warm white

**Colour temperature** 3100 K

**Luminous flux** 275 lm

**Luminous efficiency** 55 lm/W

**CRI** Ra ≥ 80

### NO-DOT EFFECT LED TECHNOLOGY

The device has a homogeneous and diffused light projection which is devoid of the speckled effect typical of traditional LED spotlights. K-PAD also integrates a special optic, which appears neutral and uniform even when the appliance is off.

**WARNING:** All light fittings must be fitted by a qualified electrician. Care must be taken where lights are enclosed in a cabinet, ensuring there is adequate ventilation. Light fittings should not be fitted in the vicinity of flammable surfaces.

ORDER ONLINE

UFORM.CO.UK

TEL: 028 79651650

FAX: 028 79651652

**uform**